

Screen Tubes

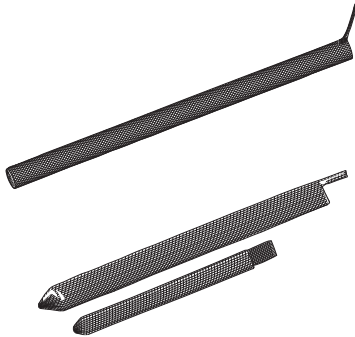

Quality Adhesive Anchoring Systems for Fastening Through Block and for Brick Pinning Applications

ADVANTAGES

HBP SERIES—NYLON SCREENS

- 30%-50% savings from stainless steel screens
- Comparable performance values
- Easier to insert and span across voids
- Flexible material is less susceptible to damage from crushing

HB SERIES—STAINLESS SCREENS

- Corrosion resistant
- Available in 1/4" to 3/4" diameters
- Special version, "dosage control" available for overhead and underwater installations

Screens Used with A7 and C6

HOLLOW CONCRETE BLOCK

Maximum holding strength in concrete block can be obtained by fastening to both the front and back of the block using an adhesive screen tube and threaded rod.

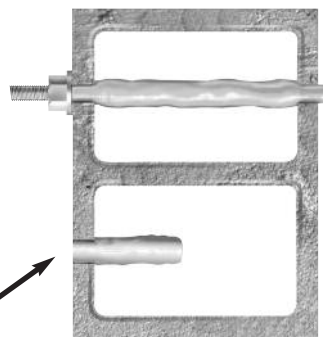

Top View

For attachments to single face of block, see page 30 for information on "umbrella anchors" and "stubby screens"

The no-drip feature of A7 adhesive makes it particularly well suited for brick pinning applications.

INSTALLATION STEPS

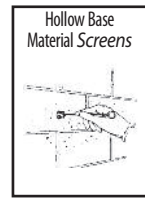

1. Drill proper sized hole, using rotation-only drilling mode. Clean out hole with forced air. Complete hole preparation with use of a brush and repeat cleaning with forced air (leave no dust or slurry).

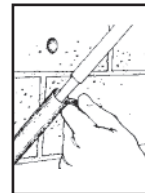

2. When starting new cartridge or new nozzle, dispense and discard enough adhesive until uniform adhesive mix is achieved. Insert the nozzle into the bottom of the screen and **fill screen completely full** (use extension tube if needed to reach bottom of screen).

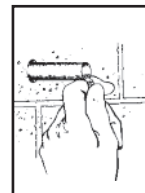

3. Insert the filled screen completely into the hole (subflush).

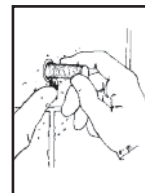

4. While holding the tab of the screen against the wall, hand insert the selected rod slowly into the screen tube with a slow twisting motion. Pull screen flush to face and coat with adhesive. Wait for appropriate cure time before torquing fixture in place.

BRICK WALL

Systems designed for Seismic Retrofit Brick Pinning or fastening to brick—various lengths and diameters available to accommodate site conditions.

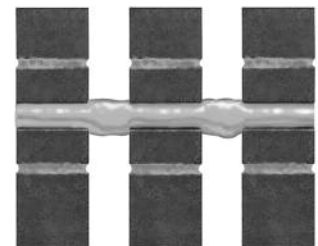

Section

ESTIMATING TABLE

Screen Tubes

Number of Anchoring Installations Per Cartridge* Using Threaded Rod and Screen Tubes with A7 and C6 Adhesives in Hollow Base Material

ROD In (mm)	DRILL HOLE DIA. INCHES	VOLUME OF CARTRIDGE	SCREEN LENGTH (INCHES)			
			6	8	10	13
1/4 (6.4)	3/8	A7 8 fluid oz.	13	10	8	
		A7 10 fluid oz.	16	12	10	
		A7 28 fluid oz.	45	35	28	
		C6 18 fluid oz.	29	22	18	
3/8 (9.5)	1/2	A7 8 fluid oz.	10	8	6	
		A7 10 fluid oz.	12	10	7.5	
		A7 28 fluid oz.	37	29	23	
		C6 18 fluid oz.	24	19	15	
1/2 (12.7)	5/8	A7 8 fluid oz.	7	5	4	
		A7 10 fluid oz.	9	6	5	
		A7 28 fluid oz.	26	18	14	
		C6 18 fluid oz.	17	12	9	
5/8 (15.9)	3/4	A7 8 fluid oz.	5	4	3	
		A7 10 fluid oz.	6	5	4	
		A7 28 fluid oz.	18	14	10	
		C6 18 fluid oz.	12	9	7	
3/4 (19.1)	7/8	A7 8 fluid oz.			2	1
		A7 10 fluid oz.			2.5	1.75
		A7 28 fluid oz.			6	5
		C6 18 fluid oz.			4	3

* These estimates do not account for waste.

SELECTION CHART

Screen Tubes

HB Stainless Screen

HBP Nylon Screen



ROD DIA. In. (mm)	SCREEN LENGTH In. (mm)	STAINLESS STEEL SCREENS		NYLON SCREENS	
		PART NO.	QTY/BOX	PART NO.	QTY/BOX
1/4 (6.4)	6 (152.4)	HB 14-6	100	*	*
1/4 (6.4)	8 (203.2)	HB 14-8	100	*	*
1/4 (6.4)	10 (254.0)	HB 14-10	100	*	*
3/8 (9.5)	6 (152.4)	HB 38-6	50	HBP 38-6	50
3/8 (9.5)	8 (203.2)	HB 38-8	25	HBP 38-8	25
3/8 (9.5)	10 (254.0)	HB 38-10	25	HBP 38-10	25
1/2 (12.7)	6 (152.4)	HB 12-6	50	HBP 12-6	50
1/2 (12.7)	8 (203.2)	HB 12-8	25	HBP 12-8	25
1/2 (12.7)	10 (254.0)	HB 12-10	25	HBP 12-10	25
5/8 (15.9)	6 (152.4)	HB 58-6	25	HBP 58-6	40
5/8 (15.9)	8 (203.2)	HB 58-8	20	HBP 58-8	40
5/8 (15.9)	10 (254.0)	HB 58-10	20	HBP 58-10	40
3/4 (19.1)	8 (203.2)	HB 34-8	20	*	*
3/4 (19.1)	10 (254.0)	HB 34-10	10	HBP 34-10	20
3/4 (19.1)	13 (330.2)	HB 34-13	10	HBP 34-13	20

* Not available in standard strength nylon screens. Longer screens available through specials.

PERFORMANCE TABLE

Load Values
Average Ultimate Loads for HBP (nylon) or HB (stainless) Screens Used with A7 in Hollow Concrete Block¹

ROD DIA. In. (mm)	DRILL HOLE DIA. In. (mm)	MAX CLAMPING FORCE AFTER PROPER CURE Ft.-Lbs. (Nm)	EMBEDMENT (SCREEN LENGTH) In. (mm)	ULTIMATE TENSION Lbs. (kN)	ULTIMATE SHEAR Lbs. (kN)
1/4 (6.4)	3/8 (9.5)	5 (6)	8 (203.2)	2,072 (9.2)	2,264 (10.1)
3/8 (9.5)	1/2 (12.7)	12 (16)	8 (203.2)	2,360 (10.5)	2,668 (11.9)
1/2 (12.7)	5/8 (15.9)	19 (25)	8 (203.2)	2,647 (11.8)	2,668 (11.9)
5/8 (15.9)	3/4 (19.1)	26 (35)	8 (203.2)	2,647 (11.8)	3,578 (15.9)
3/4 (19.1)	7/8 (22.2)	28 (37)	8 (203.2)	2,647 (11.8)	4,573 (20.3)

¹ Allowable working loads should not exceed 25% of ultimate capacity. Loads based upon testing with ASTM A193, Grade B7 rods.

PERFORMANCE TABLE

Load Values
Average Ultimate Loads for HBP (nylon) or HB (stainless) Screens Used with C6 in Hollow Concrete Block¹

ROD DIA. In. (mm)	DRILL HOLE DIA. In. (mm)	MAX CLAMPING FORCE AFTER PROPER CURE Ft.-Lbs. (Nm)	EMBEDMENT In. (mm)	ULTIMATE TENSION Lbs. (kN)	ULTIMATE SHEAR Lbs. (kN)
1/4 (6.4)	3/8 (9.5)	5 (6)	8 (203.2)	2,072 (9.2)	2,264 (10.1)
3/8 (9.5)	1/2 (12.7)	12 (16)	8 (203.2)	2,800 (12.5)	2,466 (10.9)
1/2 (12.7)	5/8 (15.9)	19 (25)	8 (203.2)	3,487 (15.5)	2,668 (11.9)
5/8 (15.9)	3/4 (19.1)	26 (35)	8 (203.2)	3,487 (15.5)	3,578 (15.9)
3/4 (19.1)	7/8 (22.2)	28 (37)	8 (203.2)	3,487 (15.5)	4,573 (20.3)

¹ Allowable working loads should not exceed 25% of ultimate capacity. Loads based upon testing with ASTM A193, Grade B7 rods.

PERFORMANCE TABLE

Load Values
Average Ultimate Loads for HBP (nylon) Screens Used with C6 in Brick and Concrete Block¹

NYLON SCREEN PART NO.	DRILL HOLE DIA. In. (mm)	SINGLE BRICK		DOUBLE BRICK		BRICK AND HOLLOW BLOCK ULTIMATE TENSION Lbs. (kN)
		ULTIMATE TENSION Lbs. (kN)	ULTIMATE SHEAR Lbs. (kN)	ULTIMATE TENSION Lbs. (kN)	ULTIMATE SHEAR Lbs. (kN)	
HBP 38-6	1/2 (12.7)	2,150 (9.6)	-- --	4,675 (20.8)	1,917 (8.5)	3,659 (16.3)
HBP 38-8	1/2 (12.7)	2,200 (9.8)	1,143 (5.1)	6,175 (27.5)	1,743 (7.8)	3,659 (16.3)
HBP 38-10	1/2 (12.7)	2,000 (8.9)	950 (4.2)	3,272 (14.6)	2,498 (11.1)	2,498 (11.1)
HBP 12-6	5/8 (15.9)	3,800 (16.9)	-- --	6,369 (28.3)	2,498 (11.1)	5,595 (24.9)
HBP 12-8	5/8 (15.9)	1,750 (7.8)	-- --	7,530 (33.5)	2,305 (10.3)	3,500 (15.6)
HBP 12-10	5/8 (15.9)	2,618 (11.6)	-- --	2,885 (12.8)	2,305 (10.3)	2,498 (11.1)

¹ Allowable working loads should not exceed 25% of ultimate capacity. Loads based upon testing with ASTM A193, Grade B7 rods.